

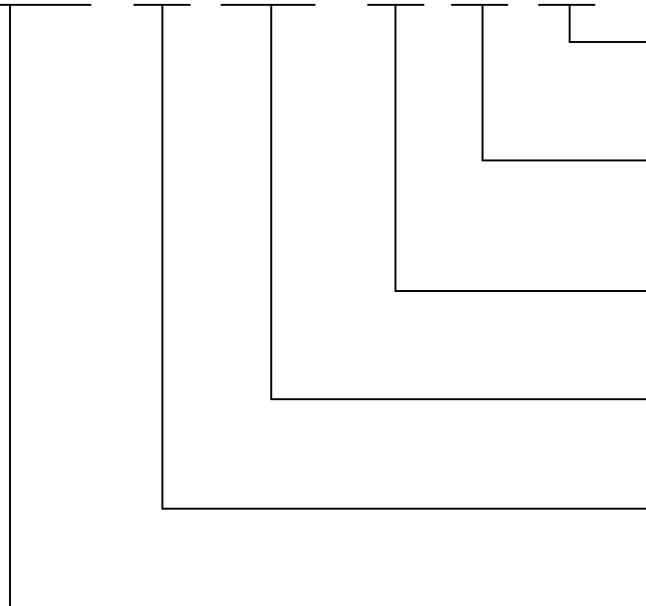

ORDERING CODE

HLS-CMA3 - H - DC12V - C - NS - ST



NIL: DUST COVER  
 ST: SEALED TYPE

NIL: WITH METAL SHOULDER  
 NS: NO SHOULDER  
 PS: WITH PLASTIC SHOULDER

CONTACT FORM  
 A: 1 FORM A; B: 1 FORM B;  
 C: 1 FORM C; U: 1 FORM U

NOMINAL VOLTAGE  
 DC6V; DC12V; DC24V

COIL  
 NIL: STANDART (1.6W)  
 H: HIGH ROWER (1.9W)

TYPE

**CONTACT DATA**

Contact Form	1A/1B/1C/1U		
Contact Material	Ag Alloy		
Contact Ratings	1A:40A/14VDC	1B 1C:30A/14VDC	1U:2×20A/14VDC
Max Switching Voltage	30VDC		
Max Switching Current	40A		
Max Switching Power	560W		
Initial Contact Resistance	100m Ω Max	at6VDC 1A	
Life Expectancy Electrical	100,000	Operations (rated load)	
Life Expectancy Mechanical	10,000,000	Operations (no load)	

**GENERAL DATA**

Insulation Resistance	100M Ω min at500VDC
Dielectric Strength Between Open Contacts	500VAC 50-60HZ (1 minute)
Dielectric Strength Between Contacts And Coil	750VAC 50-60HZ (1 minute)
Operate Time	10ms max
Release Time	10ms max
Ambient Temperature	-40°C to+85°C
Shock Resistance	10G
Vibration Resistance	10-55Hz,1.5mm double amplitude
Ambient humidity	40-85% RH
Weight	Approx 40g
Safety Standard	

**COIL DATA**

Rated Voltage (VDC)	Coil Resistance $\Omega$ ( $\pm 10\%$ )		Max Operate Voltage (VDC)	Min Release Voltage (VDC)	Max Applied Voltage (VDC)
	1.6W	1.9W			
6	22.5	19	3.9	0.6	7.8
12	90	75.8	7.8	1.2	15.6
24	360	303.2	15.6	2.4	31.2

Outline Dimension (mm)

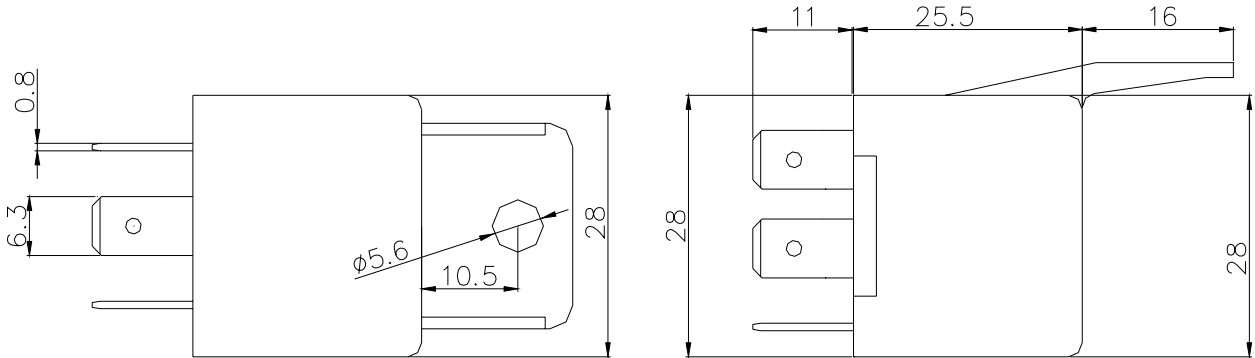

PC Board layout

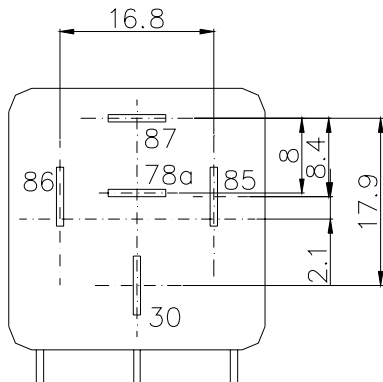

(Bottom View)

Wiring Diagram

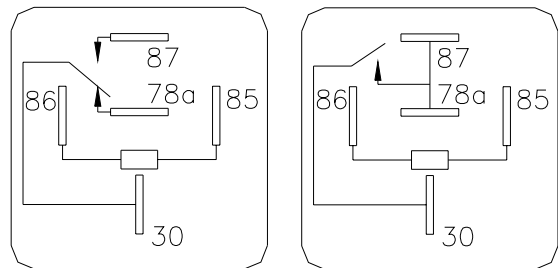

(1U)

(Bottom View)